



# PropertyNews

propertynews.com.na | 8 August 2019 | Issue 436: DIY



Just outside Windhoek  
next to Elisenheim



**SHALI** INDUSTRIAL  
ESTATE  
DREAM THE IMPOSSIBLE

## INDUSTRIAL PLOTS FOR SALE

**NO TRANSFER DUTY & NO VAT**

*Christophe: 081 124 2269 / [www.shali-industrial.com](http://www.shali-industrial.com)*



**JUSTPROPERTY**

*We'll find what is #JustRight for you.*

- SALES
- RENTALS
- BODY CORPORATES

**061 22 0673**



*Creating Wealth Through Property.*

**DoorTEC**  
GARAGE DOORS • ROLLER SHUTTERS • GATE AUTOMATION

FOR ORDERS AND INQUIRIES PLEASE CALL: +264 61 258 106  
VISIT OUR WEBSITE: [www.doortec.com.na](http://www.doortec.com.na)





**NOTE FROM THE EDITOR**

Nothing says "Welcome home" like a spick and span entryway. If the pathway to your front door is looking a little worse for wear, updating it could be possible without breaking the bank.

Turn to our centre page spread to find out more about Namclay Bricks & Pavers. It's maintenance free, durable and Namibian!

*Gerdi*

**Gerdi Fullard | Editor & Sales**  
081 146 7464  
gerdi@propertynews.com.na

**Mia Mudge | Sales**  
081 122 2637  
mia@propertynews.com.na

**Samantha Kahaangoro | Finance**  
061 235 006

**Shaun Durant | Production**  
061 235 006

**NEXT PUBLICATION:**

Issue 437 | 22 Aug 2019  
DIY

Reaching 20 000+ people monthly.  
Selling or buying, look no further than  
Property News.

facebook.com/propertynews  
www.propertynews.com.na



ADVERTISE | SUBSCRIBE | EXPLORE



**DID YOU KNOW?**

Obeco sells Chubb fire extinguishers?

**Thatch Maintenance & Fire Guard**  
**081 124 9678**



**STORE**  
all  
secure self storage

Tel: 061 236 797 | Cell: 081 252 6504  
info@storeall.com.na  
admin@storeall.com.na  
www.store-allnam.com

LAFRENZ  
25 Industria Street  
Windhoek

SOUTHERN INDUSTRIAL  
51 Parsons Road  
Windhoek

Short or long term convenient storage  
24 hour controlled access security & surveillance  
Lockable weatherproof containers  
Mini warehouse storage





TRUST ME, I'M A  
**LAWYER.**

*wkh*

DR WEDER, KAUTA & HOVEKA INC  
LEGAL PRACTITIONERS NOTARIES CONVEYANCERS

Windhoek  
Tel: 061 27 55 50

Swakopmund  
Tel: 064 443100

Grootfontein  
Tel: 067 248 700

Ongwediva  
Tel: 065 220 637

[www.wkh-law.com](http://www.wkh-law.com)



1990 SOUTH

N\$ 1 200 000

Within walking distance of all amenities. Well maintained unit with 1 Bed, 1 Bath, Kitchen & O/P Lounge. Tenant in place with good rental income.  
Lourinda 081 252 6296



EISENHEIM

N\$ 2 700 000 EXCL COST

The perfect family home! 3 beds, 2 baths, kitchen with pantry. Dining room, lounge and separate tv room. Double garage. Outside toilet & shower. Enough space for expansion. Lourinda 081 252 6296



EROS

N\$ 1 150 000

Priced to sell!!  
2 bedroom townhouse, large open plan living area, underroof BBQ area and garden. Small Pet friendly  
Johnny 081 124 8589



LUDWIGSDORF

N\$ 2 950 000 CC

Upmarket townhouse priced to go! 3 Bedrooms/3 full bathrooms/guest toilet/study, double garage & double carport/braai/pool/laundry.  
Marie 081 128 4281



BELOW VALUATION

AVIS

N\$ 1 950 000 MIL

Carmel Hills Townhouse  
3 bedroom / 2 bathroom, open plan kitchen, single garage.  
Courtyard - corner unit  
Marie 081 128 4281



RUNDU

N\$ 5 000 000

Industrial Area. Size: 27 575 m<sup>2</sup>. Zoning: Business Bulk: 1.0. Ideal location & size for a Transport Depot, DC even a medium sized shopping centre will benefit from this site! Gerhard 081 124 4682



RUNDU CBD

N\$ 2 450 000

Size: 1767 m<sup>2</sup>. Zoning: Business Bulk: 1.0. Ideally located corner plot on main road. Perfect for any business which requires high visibility & accessibility for deliveries & dispatch. Gerhard 081 124 4682



WHK WEST

N\$ 4 MIL & N\$ 3 MIL RESPECTIVELY

2 properties adjacent to each other. Zoned for Offices. 1089m<sup>2</sup> and 1055m<sup>2</sup>  
Can be consolidated.  
Lots of parking  
Denis 081 124 4581



OTJOMUISE

N\$ 700 000

Three units of approx 63m<sup>2</sup> each  
Each unit consists of: open plan lounge/kitchen, 2 bedrooms, shower/toilet and balcony/stoop.  
Denis 081 124 4581



**KLEIN WINDHOEK N\$ 4 175 000**



BELOW  
VALUATION!

Big family home on 1283m<sup>2</sup> erf. 4 beds, 2 baths, study, big kitchen, dining room, sep lounge, family room BBQ, scullery, outside laundry, pool, u/roof BBQ, SQ and 3 garages.

**OLYMPIA N\$ 3 150 000 CC**



REDUCED  
TO SELL!

Just move into this beautiful & neat 3 bedroom, 2 bathroom corner unit, with o/p kitchen & living areas, sep laundry/scullery, outside patio & BBQ, garden & dbl garage.

**ELISENHEIM N\$ 2 599 000**



MODERN AND BEAUTIFUL!! 4 beds, 3 baths, separate TV room, lounge, big designer kitchen and dining room, separate laundry/scullery, sparkling pool, storeroom and 2 shaded ports.

**KLEIN WINDHOEK N\$ 2 300 000 CC**



Cosy duet in the heart of Klein Windhoek! 3 bedrooms, 2 bathrooms, kitchen, lounge, dining room, TV room, double garage and a lovely view!

**FINKENSTEIN N\$ 23 000 PM**



TO LET

FEED THE ELAND! Lovely rustic 3 bed, 2 bath home, spacious o/p kitchen and living areas, sep laundry/scullery, family room, garage, carport, pool and outside u/roof BBQ.

Available immediately.

**AVIS N\$ 13 000 PM**



TO LET

SECURE COMPLEX. 3 bedrooms, 2 bathrooms, balconies with mountain views, o/p kitchen and living area, double garage with laundry, small garden. Available immediately.

**EROS MANOR N\$ 12 000 PM**



TO LET

BRAND NEW, MODERN & SECURE! A 3 bed, 2 bath unit, modern kitchen with sep scullery, laundry, outside BBQ, garden and dbl garage. NO stairs. Available immediately.

**AVIS N\$ 12 000 PM**



TO LET

ST MICHAELS. A secure 3 bedroom 2 bathroom unit with big living area, kitchen and separate laundry, under roof BBQ and garden and double garage. Available 1 September.

**CITY SOUTH N\$ 14 000 PM**

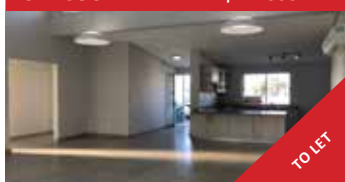

TO LET

Brand new and modern 3 bedroom flat, 2 bathrooms, spacious living areas, AC, balcony and BBQ. Tandem garage, storeroom and City Views. Available immediately.

**CITY CENTRE N\$ 10 500 PM**



TO LET

LUXURIOUS PENTHOUSE WITH 360° VIEWS! Spacious 1 bed unit, modern kitchen, living area, bathroom, u/roof BBQ & small garden, overlooking the city. 1 basement parking.

**PROSPERITA N\$ 16 000 PM**



TO LET

225 m<sup>2</sup> Warehouse, 1 office, 2 x kitchenettes and 2 x toilets. Courtyard. Available 1 August.

**WHK CENTRAL N\$ 16 000 PM**



TO LET

Approx 570 m<sup>2</sup> OFFICES with lots of parking, boardrooms, kitchenettes, bathrooms, AC. Can be let as smaller offices of 230m<sup>2</sup>, 237m<sup>2</sup> and 105m<sup>2</sup> @ Ns 140/m<sup>2</sup>. Available immediately.

Marion Wolf 081 245 2390  
 Anita Dames 081 124 6666  
 Dinette Venter 081 124 6732  
 Muggie Loftie-Eaton 081 129 4121  
 Lourette Liebenberg 081 124 5868  
 Hillie Petrus 081 128 6783  
 Stefanie Dames 081 380 9900  
 Tatjana Rapp 081 564 4373  
 Angela Ochorus 081 312 0546



www.facebook.com/RightmoveProperties  
 www.rightmoveproperties.com.na



ELISENHEIM - N\$ 2 180 000

3 Bedrooms, 2 bathrooms, huge o/p space, living / dining / kitchen /scullery, 2 single garages, veranda with bbq. Dbl volume roof. Erf 450m<sup>2</sup>. Anita 081 124 6666



ELISENHEIM - N\$ 2 550 000

3 Beds with sliding doors, 2 baths, guest loo, large o/p living-, dining and kitchen area, indoor Bbq & tandem garage. Extra Parking. Erf 450m<sup>2</sup>. Dwelling 186m<sup>2</sup> Anita 081 124 6666



OLYMPIA - N\$ 2 000 000 CC

Cozy duet house in cul-de-sac, 3 Beds, 2 baths, open plan kitchen, lounge and dining, 1 garage, carports, parking and garden. Marion 081 245 2390



ELISENHEIM - N\$ 2 550 000

3 Bedrooms, 2 bathrooms, open plan living- and dining. Modern kitchen with scullery, watercooler, blinds, splash pool, veranda with bbq, double garage, watertank, erf 650m<sup>2</sup>. Stunning View. Anita 081 124 6666



OLYMPIA - N\$ 3 420 000

Older house with lovely atmosphere! 3 Beds, 2 baths, lounge, dining room, elegant kitchen, TV-room, bachelor's flat, beautiful garden, veranda & carports. Erf: 1249m<sup>2</sup>. Marion 081 245 2390



LUXURY HILL - N\$ 5 490 000 CC

Dream of a buy! Idyllic, sunny 3 bed house with stunning location & glorious VIEWS! Spacious living areas, garden, ent areas, 3 garages. Erf size: 1684m<sup>2</sup>. Call for details. Marion 081 245 2390



HOCHLANDPARK - N\$ 2 945 000

Great offer! Very spacious and neat 4-bedroom home with big 2-bed flat. Dbl garage, pool, ent area, excellent security features. Erf size: 1036m<sup>2</sup>. Marion 081 245 2390



AUASBLICK - N\$ 6 100 000 CC

Exquisite home with trendy finishes, a wonderful atmosphere & flow; 4 beds, 3 baths, study, 2nd tv room, o/p living spaces; outside ent area; beautiful views; excellent security. Lourette 081 124 5868



WINDHOEK NORTH - N\$ 680 000

New 2 Bed T/Houses, FULL Bath, well fitted; each unit has private garden; plenty parking; great security; close to Rhino Park. Lourette 081 124 5868



PIONIERSPARK - N\$ 3 150 000

Neat well kept 4 bed house plus 2 beds outside; dbl garages; plenty parking; pool; pet friendly garden; great location. Lourette 081 124 5868



KLEINE KUPPE - N\$ 2 799 000 CC

Stunning well kept duet house. 3 Bedrooms, 2 FULL Bathrooms, study, guest loo, cosy well kept garden; erf 400m<sup>2</sup>. Lourette 081 124 5868



SHALI INDUSTRIAL  
ESTATE

D R E A M   T H E   I M P O S S I B L E

---

# INDUSTRIAL PLOTS FOR SALE

**No Transfer Duty & No VAT**

**PRICES STARTING FROM N\$ 1600/M<sup>2</sup>**

Plot sizes ranging from 1025 - 11 794m<sup>2</sup>  
2 mega watt power available to the zone

Located just outside Windhoek next to Eisenheim

**CONTACT: 081 124 2269 / [WWW.SHALI-INDUSTRIAL.COM](http://WWW.SHALI-INDUSTRIAL.COM)**

**CALL FOR  
VIEWING!**

**5 HA  
ERF!**

**SAUNA**

**MOVIE  
THEATRE**

**JACUZZI**

**WINE  
CELLAR!**

# HERBOTHSBlick BARGAIN OF THE YEAR!

**N\$ 10 500 000**



## HOUSE FEATURES

- 6 En-Suite Bedrooms
- Huge Entertainment Area
- **All Movie Theatre Furniture Included!**
- 2 Bedroom Flat With Full Kitchen
- **Furniture Alone Valued At N\$ 2.5 Mil!**

## CONTACT

**Tiffely Mouton:**  
081 242 2329  
**Michau Basson:**  
081 129 6944



*Francois Properties cc*

Director: M.A.Basson (Mrs)



# Francois Properties cc

Director: M.A.Basson (Mrs)

Contact:  
**Tiffely Mouton**  
081 242 2329  
**Michau Basson**  
081 129 6944



**LUDWIGSDORF**  
**N\$ 5 315 000**  
4 BEDS & 2 FLATS

**OLYMPIA**  
**N\$ 4 500 000**  
5 BEDS & 1 FLAT

**HERBOTHSBLICK**  
**N\$ 5 250 000**  
3 BEDS & 5 HECTARES

**AVIS**  
**N\$ 2 200 000**  
3 BEDS

**HERBOTHSBLICK PLOTS | N\$ 1 900 000 - N\$ 2 200 000**



Shawne van der Merwe  
081 255 9993  
shawne@yellowprop.com



Leaticia Coetzee  
081 260 5800  
leaticia@yellowprop.com

**AVIS - N\$ 1.7 MIL CC**



3 beds, 2 baths dbl storey Townhouse with o/p kitchen, living area. Guest toilet and single garage. Courtyard. Ample parking. Pet friendly. Safe & secure complex. **Leaticia**

BELOW VALUATION

**SWAKOPMUND - N\$ 1.7 MIL**



Newly renovated 3 bed, 2 bath home with o/p kitchen (BIC), dining & living area. BBQ, laundry room. Dbl garage. Spacious yard, alarm & ent area with balcony. Close to beach. **Leaticia**

BELOW VALUATION

**CBD WHK - N\$ 1.45 MIL CC**



Well maintained 2 bed (mes), 2 bath, one level modern apartment with o/p kitchen (BIC) & living area. Spacious courtyard. Store room. Basement parking. **Leaticia**

BELOW VALUATION

**ELISENHEIM - N\$ 1.15 MIL**



Cosy 2 bed (BIC), 1 full bath ground floor one level modern townhouse with o/p kitchen (BIC), living area. Courtyard. Own entrance with parking. Pet friendly. **Shawne**

BELOW VALUATION

**AVIS - N\$ 2.4 MIL CC**



Modern 3 bed, 2 bath dbl storey townhouse. O/p kitchen, scullery, dining area, living area. Dbl garage. Courtyard with BBQ. Ample guest parking. Pet friendly. Secure complex. **Shawne**

BELOW VALUATION

**OLYMPIA - N\$ 6.6 MIL**



5 Beds, 3 baths, kitchen, laundry, dining area, 2 living rooms, study, 2 ent areas with BBQ. Extra: 6 Offices, 2 baths, kitchenette. Pool. 2 Garages, 7 carports. Top security. **Shawne**

BELOW VALUATION



# Joanies Properties

Let experience work for you  
www.joaniesproperties.com  
joaniesproperties@gmail.com



Willem Joanie  
081 407 4274 081 129 6689

## KLEINE KUPPE - N\$ 4.170 MIL



NEW  
RELEASE

Stunner modern family home walking distance to Gymnasium school. 4 Beds, 3 baths, o/p living area with lounge, dining, kitchen & scullery, indoor BBQ, covered patio with bbq, 3 garages, pool, mezzanine for storage, solar geyser ...absolute must view!

## KLEINE KUPPE - N\$ 2.380 MIL CC



BELOW  
VALUATION

Why settle for complex living when you can own this cute home. 2 beds, 2 baths, o/p living area with lounge, dining & spacious modern kitchen, covered patio with bbq, garden, single garage, well secured. Ideal for first time buyers!

## AVIS - N\$ 1.495 MIL



SOLE  
MANDATE

Modernised townhouse in popular complex. All on one level. 2 Bedrooms, 1 full bathroom, designer modern kitchen, dining and lounge with aircon, patio with deck and bbq, dbl carport.

## FINKENSTEIN - N\$ 28 000 PM



TO  
LET

Fantastic flow. 5 Beds with 5 en-suite baths, o/p dbl volume lounge/dining/kitchen, scullery, pantry, TV room/study, wine cellar, patio with BBQ and nature views, pool, water tanks, solar power feeding to grid, Irrigation. **Furnished N\$38 000 pm.**

## LUXURY HILL - N\$ 3.695 MIL



SOLE  
MANDATE

Zoned with full office rights! Older solid home with 3 Beds, 2 baths, lounge, dining, study, kitchen, store room, double garage, pool plus 2 bedroom flatlet with bathroom, lounge and kitchen. Selling at this giveaway price! Spacious erf.

## LUDWIGSDORF - N\$ 2.3 MIL CC



Lovely duet with great views. Ideal for nature lovers. 3 Beds, 2 baths, kitchen, o/p lounge and dining with fireplace, tv room, dbl garage, garden, well secured. This home is fantastic value at this price! Do not delay, come and view this cutie!

## KLEINE KUPPE - N\$ 3.250 MIL



PRICED  
TO SELL

3 Spacious beds, 2 full baths, lounge and dining with fireplace, kitchen, scullery, pantry, solar geyser, pool, indoor bbq area at pool, covered patio with coal stove and lovely views, double garage, dbl carport, dbl shaded carport, secure, store room.

## PIONIERSPARK - N\$ 3.620 MIL CC



Modernised home on offer. 3 Beds, 2 baths, o/p living, kitchen, scullery, indoor ent with bbq, pool, water cooler, dbl garage plus spacious 2 bed flatlet, 1 full bath, o/p lounge and kitchen, indoor bbq, sep entrance with driveway, carport. Great offer!

## AVIS - N\$ 2.950 MIL CC



EXCELLENT  
VALUE

Extra spacious modern duplex townhouse on offer in popular complex. 3 beds, 2 baths, extra sep guest suite with bath and own entrance, open plan lounge, dining and kitchen, covered patio with bbq, study nook, storage, double garage.



## MERENSKY TOWERS

PRICE ON REQUEST

1 Bedroom unit in good condition, 1 bathroom with shower & toilet, lounge, modern kitchen and balcony with views. Secure entrance, bondary walls, elevator and basement parking.

Contact Samantha 081 665 0077



**Gretha Dos Santos**  
 grethads@afol.com.na | 081 284 3180  
*Nobody does property better!*

**JUST  
PROPERTY**

**OLD PIONEERSPARK**

**SUPER NEAT!**

Gretha N\$ 3.150 mil  
 Erf 1134m², 3 Beds, 1 Bath, North-facing living area with f/place, big stoep, lovely garden, pool, lapa, dbl garage, lots of parking. PLUS: 1 bed flat! Very Safe.

**EROS**

**PRICE REDUCED FURTHER!**

Gretha N\$ 3.750 mil  
 Erf 1223m². 3 beds, 2 baths, designer kitchen, living areas with f/place, patio & BBQ, garden, garage & 4 carports, top security, pool, lapa PLUS: seperate guest room & bathroom.

**ULTRA-NEAT!**

**EROS**

**NS1 MIL BELOW VALUATION!**

Gretha N\$ 3.9 mil CC  
 1200m² Erf. 3 beds, 2 baths, fitted study, huge kitchen, living areas with f/place & bar, ent room wit BBQ & bar, pool, dbl garage PLUS: 2 Bed flat & 2 offices.

**MAKE AN OFFER!**

**KLEINE KUPPE**

**MAKE AN OFFER!**

Gretha N\$ 2.965 mil CC  
 3 beds (all with aircon), 3 baths, guest loo, living room, o/p dining room & kitchen with scullery, deck & BBQ, dbl garage, off-street parking. Erf 405m², house 274m².

**FAR BELOW VALUATION**

**KLEINE KUPPE**

**ENTERTAINERS DELIGHT!**

Gretha N\$ 2.850 mil  
 Erf 400m², u/roof 241m². 3 Beds, 2 baths, top quality kitchen, huge scullery, living area with f/place, huge ent room with bar & BBQ, sparkling pool, dbl garage & dbl carport.

**INCLUDING TRANSFER COSTS!**

**KLEINE KUPPE**

**FAR BELOW VALUATION!**

Gretha N\$ 4.690 mil CC  
 4 Spacious beds each with own bath, TV room, big o/p living areas, modern kitchen & scullery, deck with views, fully tiled dbl garage, heated pool, gas & wood BBQ.

**NEAT & MODERN!**



**ANJA BASSON**  
Realty

**Anja Basson | Agent**  
**Anja Basson Realty**  
 p: 0812588360  
 e: basson.anja@outlook.com



Follow us on:



**KLEINE KUPPE - N\$ 1.865 MIL**

**Corner Unit.** Size 134m².  
 Garage & covered carport.



**KLEINE KUPPE - N\$ 2.4 MIL**

Erf size 342m². CC Registered.  
**Current valuation: N\$ 2.5 mil.**



**AVIS - N\$ 4.495 MIL**

Erf size 1476m. CC Registered. Laundry House. Sep 1 bed flat. Storage rooms.



**STOCK  
GATHERING**

**NOW LOOKING FOR**

**RENTALS**  
 up to N\$13 000pm

**PROPERTIES TO BUY**  
 up to N\$3 000 000



# Dolerite Ridge



0813394403  
0813117369  
0812955329  
0812148056  
0811283797  
0816273181  
0814539353  
0812752257

**includes 450 sqm erf**



**GRANITE** One Bedroom House

FROM **N\$595,000**

\*INCLUDES 450 sqm erf

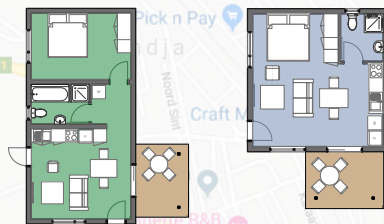

**MICA** Single Bedroom Bachelor Suite

FROM **N\$500,000**

\*INCLUDES 450 sqm erf



**AMETHYST** Two Bedroom House

FROM **N\$695,000**

\*INCLUDES 450 sqm erf

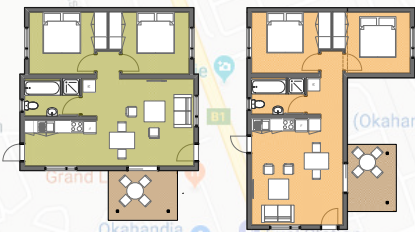

**TOPAZ** Two Bedroom House

FROM **N\$695,000**

\*INCLUDES 450 sqm erf



**SAPPHIRE** Three Bedroom House

FROM **N\$790,000**

\*INCLUDES 450 sqm erf

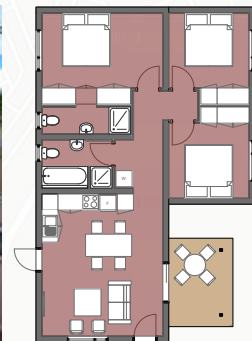

**Full Title Deed Houses**  
**450 Square Meter Erf included**  
**No Deposit**  
**Transfer Costs included**  
**Wall-to-Wall Porcelain Tiles**  
**Full Height Cupboards**  
**Tiled Roof**  
**Brick Construction**  
**Lots of Public Open Space**  
**New Suburb, Extension 7**  
**Commercial Land options**  
**Institutional Land options**  
**Kitchen Appliances & Braai incl.**

\*Terms & Conditions of Sale apply. See website for details. Contact an Agent

[www.okahandja.com.na](http://www.okahandja.com.na)

**Rental Properties  
Wanted**  
Call any of our  
agents today to  
list your property.

Chané Hälbich - 0813021268  
Zandri Scholtz - 0812478353  
Imelda Schmidt - 0817200019



Chané Hälbich  
081 302 1268



Imelda Schmidt  
081 720 0019



Zandri Scholtz  
081 247 8353

**EISENHEIM - N\$ 1.050 MIL**



Selling below valuation! 2 Bedrooms with B/C, 1 bathroom, o/p kitchen/lounge, balcony, carport. A lovely starter unit and great investment!

**ACADEMIA - N\$ 2.8 MIL**



3 Bedrooms, 2 bathrooms, entertainment area with braai, double garage, 3 carports. 1 Very large backyard flat. Valuated at N\$ 3.2 mil. The erf is 1 000m².

**LUDWIGSDORF - N\$ 40 000 PM**



N\$45000 pm furnished. Avail 1 September. Stunning property! 4 Beds, 2 en-suite, 1 bath, o/p kitchen/lounge/dining, laundry, home office, 2nd lounge, ent area to die for!

**PIONIERSPARK - N\$ 1.250 MIL**



Newly renovated townhouse with 2 beds, main bedroom with a/c, o/p kitchen/lounge with a/c, bathroom, low maintenance courtyard, 1 undercover parking.



Like us on facebook



**WINDHOEK  
PROPERTY BROKERS**

*The Key To Your  
Property*

Our **NEW OFFICES** are located in the Metro Building/  
Fruit & Veg in Kleine Kuppe.

**OPENING PROMOTION!**

LIST or BUY a property with one of our qualified agents  
in the month of AUGUST - SEPTEMBER 2019 and stand a  
chance to **WIN WIN WIN N\$ 10,000.00 in the lucky draw!**  
Draw date: 30 November 2019

- |         |                           |
|---------|---------------------------|
| Ria     | 081 129 9400              |
| Julie   | 081 129 9700              |
| Ruanca  | 081 237 0071              |
| Tinkie  | 081 268 8960              |
| Silla   | 081 227 5011              |
| Stella  | 081 208 8815              |
| Marieta | 081 124 8701              |
| Ronel   | 081 242 6396 (Swakopmund) |
| Renate  | 081 242 0008 (Swakopmund) |





# Journeying together towards you brand new kitchen.

With our financially sound pre-approval certificate, you only need a Deed of Sale and a Valuation Report to purchase your new home.

Call our Property Finance branches to find out more:

**Alna Geldenhuys**  
Windhoek  
Tel: +264 61 299 0525

**Serafina Haiping**  
Ongwediva  
Tel: +264 65 232 858

**Anita Beukes**  
Walvis Bay  
Tel: +264 64 219 640

**Sharon Yakeya**  
Rundu  
Tel: +264 66 266 722



**Bank Windhoek**  
a member of **Capricorn Group**



TO LET

**WESTLANE** **NS7,990 pm**  
Pionierspark Ext 1 **Incl. N\$300 water**

Spacious apartments on first or second floor, in popular family-friendly complex, offering:

- 2 Bedrooms
- Open-plan kitchen-living area
- Balcony with built-in braai
- Solar geyser saves electricity
- Secure basement parking
- Playground & basketball court
- Separate "quiet park" for relaxing

Convenient location next to Westlane Shopping Centre and walking distance from Windhoek International School. Only 10 min drive to UNAM.



TO LET

**IMANDRA** **FROM NS8,950 pm**  
Kleine Kupe **Incl. N\$250 water**

Modern and bright apartment in security complex, offering:

- 2 Generous bedrooms
- Full bathroom (bath & shower)
- Open plan design with built-in braai
- Modern kitchen, granite countertops
- Solar geyser saves electricity
- Air conditioning & house alarm
- Lockup single garage
- Additional parking available

Close to the Grove Mall and Lady Pohamba Hospital. Only 5 min drive to Windhoek Gymnasium and 10 min drive to UNAM.



TO LET

**INYATI** **NS8,350 pm**  
Kleine Kupe **Incl. N\$250 water**

Spacious pet-friendly duplex townhouse, offering:

- 2 Bedrooms
- Full bathroom (bath & shower).
- Open-plan kitchen-living area
- Private courtyard with built-in braai
- Dedicated undercover parking
- Quiet security complex

Conveniently close to the Grove Mall and Lady Pohamba Hospital, only 5 min drive to Windhoek Gymnasium Private School and less than 10 min drive to UNAM.



TO LET

**VAL D'RHYN** **NS7,480 pm**  
Pionierspark Ext 1 **Incl. N\$200 water**

Modern & spacious apartment in popular security complex, offering:

- 1 Bedroom with ensuite
- Practical open-plan kitchen-living
- Private courtyard
- Air conditioning
- Allocated basement parking
- Children's playground on-site
- Ample visitor's parking on-site

Ideal location close to Westlane Shopping Centre and Windhoek International School, only 10 min drive to UNAM.

# Call us for all your property rental needs

☎ 061 300 327  
[www.npr.com.na](http://www.npr.com.na)

Follow us  

**Speak to an agent  
today:**

Jenny-lyne 081 128 8811

Zola 081 293 5565

Liselle 081 400 1617

Bernie 081 148 8510



**namibia property rentals**



Call us for a  
viewing!



**Made in Uis**

**Namibia clay bricks**

**Therma Comfort Insulation**

**Environmentally Friendly**

**NAMCLAY**  
**BRICKS & PAVERS**  
Namibian Clay Bricks Made in Uis

**Fire and Sound Proof**

**Maintenance Free**

**Aesthetics**

**Durable**

**We understand the language  
of bricks!**



**Tel:** +264 (0)64 504 126  
**Fax:** +264 (0)64 504 223  
**Email:** sales@namclay.com  
**Web:** www.namclay.com



## The many **FACES** of clay bricks

### FBA - Face Brick Aesthetic

Clay bricks that are selected or produced for their durability and aesthetic effect deriving from nonuniformity of size, shape and colour.

### FBA (dark) - Face Brick Aesthetic

Clay bricks that are selected or produced for their durability and aesthetic effect deriving from nonuniformity of size, shape and colour.

### FBA (Rock Face) - Face Brick Aesthetic

Clay bricks that are selected or produced for their durability and aesthetic effect deriving from nonuniformity of size, shape and colour.

### NFX - Non-Facing Extra

Clay bricks suitable for use, plastered or unplastered, for general building work below damp-proof course or under damp conditions or below ground level where durability rather than aesthetics is the criteria for selection.



## WHY

## clay bricks are **BETTER**

The **MAXI BRICK** is a 25 + MPa, 36 Bricks per square meter, maxi brick is a plaster or non plaster brick 340 Bricks on a pallet.

### Timeless durability

Clay bricks are good for centuries of service. In Europe there are brick buildings as old as 800 years still standing today. Modern brick-making techniques produce clay bricks that are even more durable.

### Value for money

Clay bricks are inexpensive taking into account their immense durability and very low maintenance. First cost of an unplastered wall is final cost.

### In demand

Clay brick homes are always in demand because clay bricks do not deteriorate, never go out of fashion and always look their best.

### Fire resistant

The fire resistance of a building refers to the length of time a walling element is able to resist a fully developed fire. In every case, clay brick walls obtain maximum fire ratings.

### Insulation

Clay bricks insulating properties. Not only do they muffle sounds from traffic and city noise, clay bricks insulate against cold in winter and heat in summer.

### Maintenance free

A clay face brick house is maintenance free for life. It retains its aesthetic appeal year after year.





**KLEINE KUPPE - N\$ 1.050 MIL**



**SOLE MANDATE**  
 1 Bedrooms/1 Bathroom/1 Parking Bay  
 \* North Facing corner unit on top floor  
 \* Private & Secure near all amenities  
 \* 24 hour security, Aircon & Alarm

**CBD - N\$ 2.9 MIL**



**SOLE MANDATE**  
 2 Bedrooms/2 Bathrooms/1 Parking  
 \* Spacious, North facing 141m<sup>2</sup> unit  
 \* Balcony with views; private entrance  
 \* Excellent fixtures and fittings

**ACADEMIA - N\$ 2.890 MIL**



**JOINT MANDATE**  
 5 Bedrooms/3 Bathrooms/1 Flat/1 Garage  
 \* Spacious corner erf of 1084m<sup>2</sup>  
 \* All on 1 level family home; pool & ent area  
 \* Kitchen + scullery & laundry; fireplace

**LUDWIGSDORF - N\$ 2.6 MIL**



3 Bedrooms/2 Bathrooms/2 Garages  
 \* In quiet street with views  
 \* Kitchen, dining, living room with fireplace  
 \* Spacious garden; extra entrance & parking

**AVIS - N\$ 1.590 MIL**



2 Bedrooms/1 Bathroom/1 Garage  
 \* All on 1 level, North facing  
 \* In a quiet, well managed complex  
 \* Small garden; Excellent security

**LUDWIGSDORF - P.O.R.**



4 Bedrooms/4 Bathrooms/3 Garages  
 \* In quiet cul-de-sac, private with views  
 \* Kitchen with granite tops, scullery  
 \* Pool, ent area, study, playroom; parking

**GOLFER'S INN  
 N\$ 2.7 MIL CC**

3 Bedroom Townhouse with  
 2 bathrooms, double garage  
 and top security.

**Contact Andre  
 081 129 6595**

**HENTIES BAY  
 N\$ 1.7 MIL**

Seafront vacant erf of  
 1000m<sup>2</sup> on Henties Bay's  
 North Dune.

**Contact Andre  
 081 129 6595**



# TO LET FROM N\$5050 APPLY NOW & PAY NO DEPOSIT\*



## WORK IN WINDHOEK LIVE & PLAY IN OKAHANDJA

An easy 48 min commute to Windhoek  
Car Pool with Family & friends to work and  
enjoying more cash in pocket every month!



24H



Prime



Playpark



Geyser



Savings

Close to shopping centres & more

Quality finishes & fittings

24 hour security & gate control access  
(Vehicular and Pedestrian)

Jungle Gym/Children's play area

Solar Geysers & Green Edge Compliance



## BRAND NEW 2 BED APARTMENTS

(\*T's & C's Apply. Limited Offer)

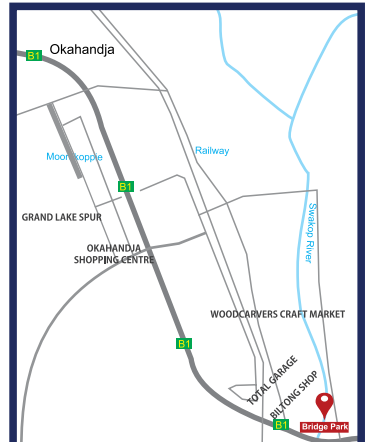

ON SHOW DAILY:  
MON - FRI: 09:00–17:00  
SAT & SUN: 10:00–14:00

IDEALLY SITUATED FOR AN EASY COMMUTE FROM WINDHOEK  
WWW.IHSPM.COM.NA | PHONE 081 416 9369 | LEASING1@IHSPM.COM.NA



# #PROPERTY

Contact us at: Windhoek +264 61 257 974/5

Email address: info@aucornamibia.com

www.aucornamibia.com

## PROPERTY AUCTION

### OSHIKUKU, OMUSATI REGION:

Erf 1, Oshikuku, Omusati Region - Size 646 m<sup>2</sup>

- Roma Shopping Center

#### Vacant erven :

Erf 2 - Size 713 m<sup>2</sup>

Erf 243 - Size 304 m<sup>2</sup>

Erf 258 - Size 1009 m<sup>2</sup>

Erf 647, Ext 1 - Size 842 m<sup>2</sup>

Erf 1446, Ext 4 - Size 2035 m<sup>2</sup>

Erf 242 - Size 662 m<sup>2</sup>

Erf 244 - Size 304 m<sup>2</sup>

Erf 259 - Size 862 m<sup>2</sup>

Erf 1123, Ext 4 - Size 2676 m<sup>2</sup>

### ONDANGWA, OSHANA REGION:

Erf 1766 - Size 2782 m<sup>2</sup>

- Workshops, Offices, Storerooms, Ablution & Under roof Workshop

Erf 1767 - Size 2782 m<sup>2</sup>

- Workshop, Storeroom, Office, Reception, Bedroom with Bathroom & Kitchen

Erf 1768 - Size 2782 m<sup>2</sup>

- Workshop & Offices

Erf 2061 - Size 756 m<sup>2</sup>

- 3 Bedrooms, Family Room, Lounge, Dining Room, Kitchen,

2 Bathrooms, 2 Garages & Carports

Erf 6912 - Size 1326 m<sup>2</sup>

- 3 Bedroom House, 2 x Workshops

Erf 1764 & Erf 1765, Erf 1178 - Size 2438 m<sup>2</sup> combined

- Office & Steel Shed

#### Vacant Erven:

Erf 4798 - Size 4246 m<sup>2</sup>

Erf 968 - Size 806 m<sup>2</sup>

### OSHAKATI, OSHANA REGION:

Erf 1111, Omulunga Court, c/o Jakalsbessie & Khamé Nkurumah Str.

Oshakati East - Size 2030 m<sup>2</sup>

- 16 x units @ 93 m<sup>2</sup> - 2 Bedrooms, Lounge/Kitchen & Bathroom

Erf 1202 - Size 1570 m<sup>2</sup>

- 5 Bedrooms, Bathroom, Guest Toilet, Lounge, Family Room, Study,

Kitchen, Dining Room, Laundry & Garage

### EENHANA, OHANGWENA REGION:

Erf 496 - Size 375 m<sup>2</sup>

- 3 Bedroom, 2 Bathrooms, Lounge & Kitchen

Erven 899 - 902 - Size 4169 m<sup>2</sup>.

- 29 x 2 Bedroom Flats, 2 Bathrooms, Kitchen & Lounge

### ONGWEDIVA, OSHANA REGION:

Erf 1768, Ext 5 - Size 2782 m<sup>2</sup>

- Warehouse, Offices & Ablution

### OSHIKANGO, OHANGWENA REGION:

Erf 1218 & 1219 - Size 1792 m<sup>2</sup>

- Warehouse, 2 x 3 Bedroom units with WC. One unit has Kitchen &

Lounge, Carport, Veranda & Boundary Wall

Erven 120 - 123 - Size 1200 m<sup>2</sup> each

- Warehouse, 11 x Shops each with 2 Bedroom Flat, Kitchen,

Shower/WC & Separate WC, Water tanks, 2 Phase power supply &

2 Generators

Portion 22 (Erf 1583) - Size 3647 m<sup>2</sup>

- Double Volume Warehouse, Double Storey Showroom,

2 x 2 Bedroom Flats, 2 Outside Rooms, Water tanks, Washing Bay,

Central Cooling, Aircons, Alarm & Electric Fence

Erf 299 - Size 1000 m<sup>2</sup>

- Block of 10 Flats



Date: Friday  
30 August 2019  
@ 10:00

Venue: Oshakati  
Guesthouse, Oshakati

DULY INSTRUCTED BY OUR CLIENTS,  
AUCOR NAMIBIA (PTY) LTD, WILL SELL  
THE FOLLOWING PROPERTIES ON  
PUBLIC AUCTION:

## OSHAKATI



Erven 899 - 902 - Size 4169 m<sup>2</sup> (Combined)

- 29 x 2 Bedroom Flats, 2 Bathrooms, Kitchen & Lounge



## EENHANA

Erf 1111, Omulunga Court, c/o Jakalsbessie & Khamé

Nkurumah Str. Oshakati East - Size 2030 m<sup>2</sup>

- 16 x units @ 93 m<sup>2</sup> - 2 Bedrooms, Lounge/Kitchen & Bathroom



## OSHIKANGO

Erf 299, Oshikango - Size 1000 m<sup>2</sup>

- Block of 10 Flats

Registration: N\$2000.00 by bank transfer or cash only. Copy of ID upon registration. Property will be sold subject to confirmation. 10 % payable on fall of hammer. Finance must be approved prior to bidding. Buyers being financed must produce an irrevocable letter of credit within 14 days after sale. Details subject to change without prior notice. Pre-auction offers up to 7 days prior to auction will be considered.

# DRIE KRONE

**ESCAPE** from the noise and fast pace of the city to enjoy nature and the starry sky of our Heavenly Father with friends and family.

Only 55 km outside of Windhoek with its own water sources. Only 26 units on a 100 hectares!



**Discover** quality of life on the farm at only N\$ 3800 per month.

For more info or a tour of Drie Krone, contact Andre Gous or Willem Gous at  
081 129 6595  
081 122 1231  
[willem2@pfsnam.com](mailto:willem2@pfsnam.com)



**OLD HOCHLANDPARK - N\$ 2.4 MIL EXCL**



**Valuation N\$ 3.1 mil.** 4 bedroom house on a main road, plus a 1 bed flat on 1000m<sup>2</sup> even erf, 3 minutes drive to city centre. Can be used as a guest house (already has license), or any other business. Flat rented for N\$ 6000 pm.

**ONDANGWA - N\$ 2.4 MIL CC**



**Business/ind zoned plot.** Price incl transfer of cc. Size 6,437m<sup>2</sup>. Flat erf and fully serviced. Highly growing area, excellent main road location to Oshikango. Perfect location for transport company, warehousing, factory, sme park, etc. Valuation: N\$2.9 mil.

**KLEIN WHK - N\$ 3.2 MIL EXCL**



**4 bedrooms, 2 bathrooms,** double garage double carport, pool entertainment area plus 2 outside flats. Recent valuation: N\$ 4,25 million. All on one level and flat erven, also perfect for an office, a business or work from home setup.

**WHK WEST - N\$ 2.7 MIL EXCL**



**Freestanding house - office zoned.** 3 bedrooms, 1 bathroom, outside room, Garage, around 1000m<sup>2</sup> plot. If you ever wanted to own your own office, this is your chance. Recent Valuation: N\$ 3.6 million.



# HENNING VILLAGE

**TO LET**  
**N\$ 23 000 pm**  
**Negotiable**

**Modern Luxury Villa**  
**with great views available for rent!**  
**Also Available For Sale!**

Features include:

- 3 Bedrooms
- Main with own balcony
- Walk-in closet & Aircon
- 2 Bathrooms
- Guest Toilet
- Open plan kitchen with BIC
- Gas stove
- Double volume living area
- Double garage
- Double IBR carport
- Domestic wc
- Covered patio
- Splash pool
- BBQ

**Contact Samantha**  
**081 665 0077**

# Congratulations to the FNB Realtors Club Far North winners 2019



### Far North Estate Agent and Agency of the Year

*Left to Right:* Magda Talbot (FNB); Roswitha Haingura, Haingura Real Estates and Tomas Iindji (FNB)

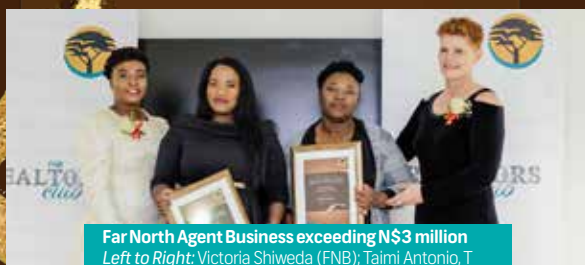

### Far North Agent Business exceeding N\$3 million

*Left to Right:* Victoria Shiweda (FNB); Taimi Antonio, T Antonio Real Estate; Selma Iithete, Tuyeni Real Estate and Magda Talbot (FNB)



### Far North Agent Business exceeding N\$5 million

*Left to Right:* Victoria Shiweda (FNB); Jeanette Shakumu on behalf of Kaino Shakumu, Ediva Real Estates and Magda Talbot (FNB)

# FNB

FNB  
REALTORS  
club

**MONDRA HAVEN - NEW DEVELOPMENT - MONDESA SWAKOPMUND - N\$ 485 000**

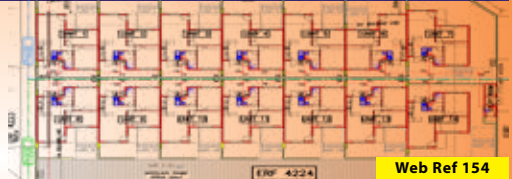

Web Ref 154

21 x 2 Bedroom Units, 1 bathroom, built in kitchen and open plan living plus carport.  
Dwelling: 60m<sup>2</sup>. Small yard 60m<sup>2</sup>.

**CITY CENTRE APARTMENT - N\$ 2 550 000**



SOLE  
MANDATE

Web Ref 290

Dwelling 236m<sup>2</sup>. Erf 600m<sup>2</sup>. Ocean View U-Shaped, 3 Beds, secure with a lot of safety features, 2 baths, big courtyard, dbl garage.

**DIVINE HOMELY TOUCH - N\$ 1 380 000 CC**



Web Ref 240

Dwelling: 177m<sup>2</sup>. Duplex townhouse, 3 beds, 2 baths, 2 guest toilet, kitchen, dining area, living/ent area with a b/i braai, single garage.

**DIVINE HOMELY TOUCH - N\$ 2 350 000**



Web Ref 148

Dwelling: 328m<sup>2</sup>. Erf 803m<sup>2</sup>. Reduced by N\$1 mil!! New 3 bed house with 2 bed flat, 3 garages, 2 baths, o/p living, indoor BBQ.

**PRIVATE SALE**

Contact Robert  
081 228 7577



**SWAKOPMUND**  
**N\$ 3.5 MIL**

**Modern finishes**  
Quality building; Secure  
3 Bedrooms & 2 Bathrooms  
Open plan kitchen, lounge & dining room  
Solid wooden floors; Balcony  
Large tiled tandem garage with shelves  
Close to town and beach next door

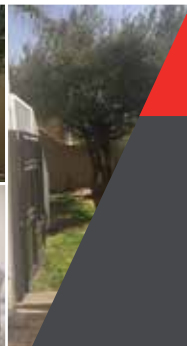

**THE PINNACLE**  
**KLEIN WHK - N\$ 3.5 MIL**

**Safe, Secure & Private; 286m<sup>2</sup>**  
3 Bedrooms & 2 full bathrooms onto big balcony  
Study & 1 Guest toilet  
Open plan kitchen, lounge & dining room  
Entertainment room with BBQ  
4 x aircons; 300L Solar geyser  
Easy maintenance garden  
Double garage

# iTyre

INDEPENDENT TYRES (PTY) Ltd t/a iTyre

|            |               |
|------------|---------------|
| WINDHOEK   | (061) 444 350 |
| SWAKOPMUND | (064) 418 080 |
| ORANJEMUND | (063) 234 935 |
| MARIENTAL  | (063) 240 848 |
| WAREHOUSE  | (061) 223 235 |

- PASSENGER TYRES
- MINING TYRES
- TRUCK TYRES
- OTR TYRES
- 4x4 TYRES
- RETREADS
- TUBES

- BATTERIES
- TYRE REPAIRS
- ACCESSORIES
- WHEEL ALIGNMENT
- WHEEL BALANCING
- 24/7 BREAKDOWN SERVICES



**SUSAN**  
081 275 7929



**LORIN**  
081 332 8037  
LANGSTRAND AGENT

**SWAKOPMUND - N\$ 1.365 MIL**



**BARGAIN!!** Townhouse close to shopping mall & schools. Safe complex with e/fence & security. 3 beds, 2 baths, indoor BBQ, o/p lounge, dining and TV room plus garage.

**SWK CENTRAL - N\$ 5.8 MIL**



**SEA VIEWS AND VIEWS OF THE MOLE** Luxury Sea View apartment in sought after complex. Spacious living area, 3 beds, 2 baths, dbl garage. Large terrace/garden area.

**SWAKOPMUND - N\$ 2 900 000**



**SWAKOPMUND RETIREMENT VILLAGE** Enjoy a carefree retirement with the security of full ownership. House offers 2 Beds, 2 Baths, sunny and spacious living area, Dbl Garage.

**LANGSTRAND - N\$ 2.7 MIL**



**FREESTANDING HOUSE.** Ideal for a big family. Pet friendly. 4 Beds, 2 full baths, o/p living area, kitchen & scullery/laundry. Indoor BBQ, DQ's, 3 Garages. Wooden deck & Boma.

**LANGSTRAND - N\$ 2.950 MIL CC**



**BEACHFRONT TOWNHOUSE** 3 Bedrooms, 3 Bathrooms, open plan living area, kitchen, scullery, indoor BBQ, wooden deck for outdoor living and double garage.

**LANGSTRAND - N\$ 3.650 MIL**



**BEACHFRONT HOUSE** 3 Bedrooms, 3 Bathrooms, open plan living area, kitchen, scullery/laundry, Indoor BBQ and double garage.



Tel 064 402 349 | [info@schroeder-estate.com.na](mailto:info@schroeder-estate.com.na) | 11 Daniel Tjongarero Str, Swakopmund, Namibia

Anja | 081 252 8877  
Frank | 081 129 4770



**ROSSMUND N\$ 3 395 000**



Luxurious residence with semi-enclosed patio & outdoor braai. Low maintenance garden. Lounge/ dining area with fireplace, aircon in selected rooms.

**HAGE HEIGHTS N\$ 3 200 000**



Beautiful light-filled family home in a quiet upmarket residential area. Enjoy the tranquility of the large sculptured garden. Free standing fire place.

**ROSSMUND N\$ 1 750 000**



Stylish 2 bed sectional title unit set amidst lush garden areas in this quiet sunny retreat just outside of Swakopmund. Roof terrace offers good views of the Swakop River.

**INVESTMENT OPPORTUNITY**



Pathcare Body Corporate commercial sections 1, 2, 4 & 5 (80m<sup>2</sup> - 96m<sup>2</sup>) each with: Reception / consulting area, kitchenette & W.C. From N\$ 1 128 850.00 excl. VAT.

**WATERFRONT N\$ 1 135 000**



At the end of a cul-de-sac, in well established neighbourhood. Close to seafont and shopping mall, yet away from traffic in quiet area. Ideal for your dream house! 755m<sup>2</sup>

**VINETA N\$ 4 500 000**



Prime residential area, close to the beach. This 3 bed, 2 bath home has a beautiful private garden and built-in fire place. Double garage & 1 bedroom guest flat.

**KRAMERSDORF N\$ 6 850 000**



Space galore with outstanding views of the dunes! Generous lounge & dining area with bar & braai to patio from where to enjoy leisure sundowners.

**CBD N\$ 2 480 000**



Perfect location near Mole and CBD. 2 Bedrooms & study / guestroom, 2 bathrooms, kitchen & pantry, dining / lounge. Double garage. In superb condition.

info@auasflooring.com  
Tel: 061 305 423  
www.auasflooring.com

# AUAS FLOORING

FOR THAT *elegant* FEELING



Solid wood flooring  
Laminated Wood  
Flooring  
Carpets

Tiles & Vinyl Flooring  
Wallpaper  
Blinds  
Shutters

An advertisement for aluminium security shutters. The background shows a row of white, louvered shutters installed on a wall. A central white box contains the text 'ALUMINIUM SECURITY SHUTTERS'. To the right, a blue diagonal banner says 'CONTACT US FOR A FREE QUOTE'. On the left and right sides, there are circular icons with text: 'HIGH LEVEL SAFETY' (lock icon), 'INTERNAL OR EXTERNAL' (shutter icon), '30 YEAR GUARANTEE' (checkmark icon), 'ECO-ENVIRO FRIENDLY' (recycling icon), and 'SHORT LEAD TIME' (clock icon).

## ALUMINIUM SECURITY SHUTTERS

CONTACT US  
FOR A FREE QUOTE

HIGH LEVEL  
SAFETY

INTERNAL OR  
EXTERNAL

30 YEAR  
GUARANTEE

ECO-ENVIRO  
FRIENDLY

SHORT LEAD  
TIME

## Shade Centre cc

### BEAUTIFULLY SAFE | SECURITY SHUTTERS WITH STYLE

Strong, safe & beautiful shutters that will provide you with peace of mind!  
High level safety, Internal or External Use & 10 Year Guarantee.

Tel: 061 301 845 | Cell: 081 124 9685 | 43 Nickel Str, Prosperita



**SWAKOPMUND**

**FROM N\$ 895 000**

**MATATURA VILLAGE - NEW DEVELOPMENT!**  
Affordable Housing Now Available!  
Only 14 units available - Modern design  
2 Designs to choose from either 2 or 3 bedrooms  
Web ref 1286476



**SWAKOPMUND**

**N\$ 1.780 MIL**

Stylish & welcoming family home. This functional home comprises of a sunny o/p living area & classic kitchen with sep scullery leading out to relaxing outside ent area with a braai. 3 Beds, 2 Baths, 2 garages. Web ref 1286877



**SWAKOPMUND**

**N\$ 1.995 MIL**

Neat 3 bedroom house with 1 bedroom flat. Entrance into an open plan living, dining room and kitchen with built-in cupboard and stove. 3 Bedrooms, 2 Bathrooms, 2 Garages  
Web ref 128317

Visit our website for more available properties on [www.realtorsnamibia.com](http://www.realtorsnamibia.com)



**LONGBEACH**

**N\$ 2.4 MIL**

**BRAND NEW!**  
Modern design family home close to the beach!  
Quality finishes throughout.  
CC Registered (Saving on transfer duties)  
3 Bedrooms, 2.5 bathrooms, study, 2 garages  
Web ref 1248806



**LONGBEACH**

**N\$ 1.850 MIL**

Attractive home perfect for holidays!  
**FURNITURE INCLUDED IN PRICE!**  
Open plan living with kitchen / dining / lounge with built-in braai, lounge opens up with sliders towards courtyard. 3 Beds, 2 Baths, 2 Garages.  
Web ref 1248602



**OKA-HANDJA**

**N\$ 970 000**

Ready to move in...  
Affordable Home with potential for expansion on spacious yard.  
2 Bedrooms, 2 Bathrooms, 1 Garage  
Web ref 1289530



**VOLLGRAAFF**  
REAL ESTATE  
[www.vre.properties](http://www.vre.properties)



**N\$ 1 050 000**

**TOP FLOOR APARTMENT BY THE BEACH**  
Perfect for a breakaway weekend. Investment for long term rental.

2  2  1 



**N\$ 1 550 000 NEG**

**MOTIVATED SELLER...**  
Santorini Court Townhouse  
Make me an offer!

2  2  2 



**N\$ 4 750 000**



**SPACIOUS ENTERTAINER IN A CONVENIENT LOCATION**  
Large home with lapa, braai and established garden. Outside bed with bath.

3  3  4 

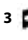
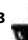

**N\$ 2 450 000**

**UNDER CONSTRUCTION VALUE FOR MONEY**  
Spacious with exposed beams & high ceiling. Designer home

3  3  4 

**SIMONE VERMAAK**  
C: 081 403 6646  
E: [rent@vre.properties](mailto:rent@vre.properties)

**SWAKOPMUND**

**ANISKA VOLLGRAAFF**  
C: 081 861 7135  
E: [aniska@vre.properties](mailto:aniska@vre.properties)

# HOME CORP

MEGA STORE • MEGA SAVINGS

## WINDHOEK

SHOP 14 MAERUA  
LIFESTYLE CENTRE  
(061) 303 840

## SWAKOPMUND

CNR SCHLACHTER AND  
MOSES GAROEB STREET  
(064) 419 600

[www.homecorp.africa](http://www.homecorp.africa)

 Home Corp Namibia

 Home Corp Namibia

# **PG** Glass

## **NAMIBIA**



WHAT ARE YOU LOOKING FOR?



SINGLE GLAZING



DOUBLE GLAZING



COMFORT AND  
ENERGY SAVINGS



INTERIOR DESIGN  
SOLUTIONS



SAFETY AND  
SECURITY



SPECIALISED

We specialise in: Mirrors, Float glass, Colourvue, Solarvue, Solarshield, Low-E, Solar-E, Bulletproof, Toughened, Armourolams, Frameless Showers and Doors, Primador Showers and Doors. Whatever you need, PG Glass is the place to ask for it.

Now also: Glass & Mirror Installations, Perspex and Framed Mirrors.

Windhoek Building Glass - 061 287 5000  
083 387 5000

Swakopmund - 064 406 980

Walvis Bay - 064 204 102

Otjiwarongo - 067 304 510

Oshakati - 065 222 143



# **We ARE glass**

# FLIGHT SCHEDULE:

MONDAY, WEDNESDAY and FRIDAY.

## DEPARTURE

06:30 EROS WINDHOEK  
08:00 ONDANGWA  
17:45 EROS WINDHOEK  
19:15 ONDANGWA

## ARRIVAL

ONDANGWA 07:30  
EROS WINDHOEK 09:00  
ONDANGWA 18:45  
EROS WINDHOEK 20:15

09:30 EROS WINDHOEK  
16:00 ORANJEMUND

ORANJEMUND 10:45  
EROS WINDHOEK 17:15

## SUNDAY

### DEPARTURE

17:00 EROS WINDHOEK  
18:30 ONDANGWA

### ARRIVAL

ONDANGWA 18:00  
EROS WINDHOEK 19:30

It's about **time.**

[www.flywestair.com](http://www.flywestair.com) | [fly@westair.com.na](mailto:fly@westair.com.na) | 083 339 0069

